

SCALE: 1:2

## PROPOSED SIGN LAYOUT NORTH BUILDING FACE

NAVY BLUE BACKGROUND  
COLLEX = WHITE COLLISION EXPERTS = RED

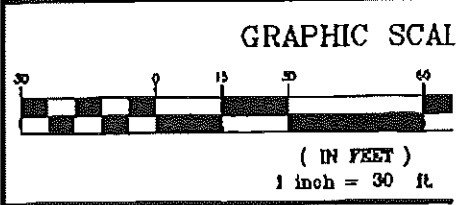
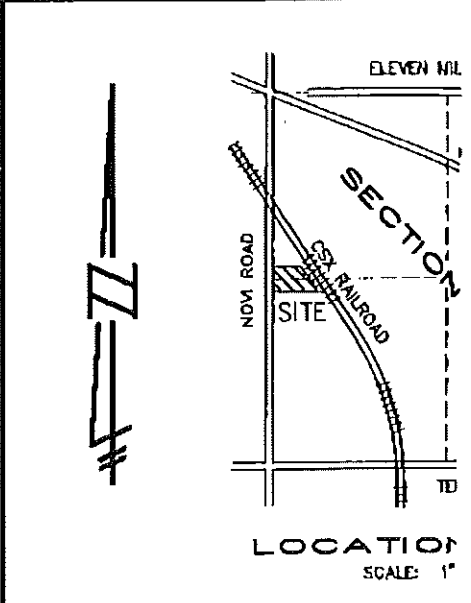
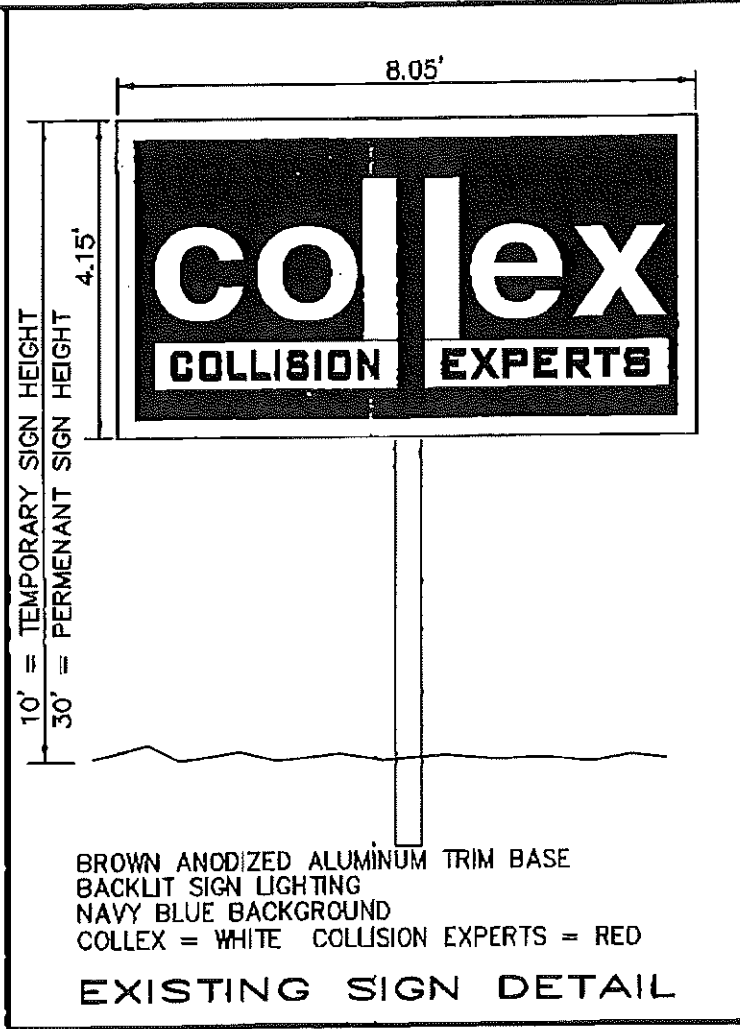
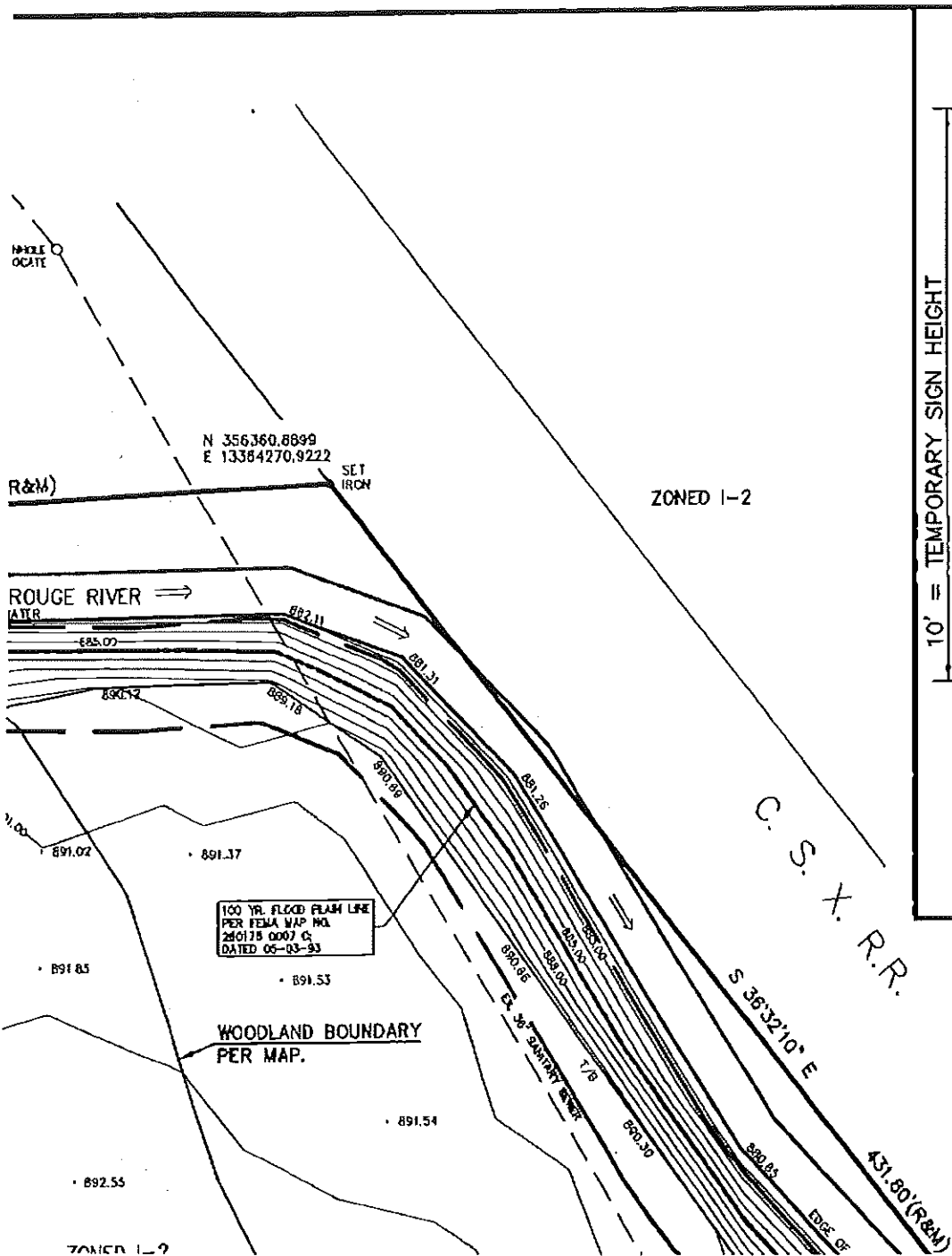

**Subject Property**  
 Legal Description (SIDWELL NO. 50-22-2)

A part of the West 1/2 of Section 23, East, City of Novi, Oakland County, Michigan, particularly described as commencing at of said Section 23 for the Point of Beginning North, 177.45 feet, along the West line of the centerline of Novi Road (60.00 foot thence North 89°39'00" East, 416.78 feet; 36°32'10" East, 431.80 feet; thence North 00°01'23" West, 164.45 feet, along the West line of said Section 23 and the centerline of said Novi Road Beginning. All of the above containing the above being subject to easements, rights-of-ways of record. All of the above the rights of the public in Novi Road. Gross Land Area 4.327 Acres

**SOIL INFORMATION**  
 PER THE SOIL CONSERVATION SERVICES OAKLAND COUNTY AREA AREA, MICHIGAN (DATA AND REVISIONS JULY 2001. THE SI