

# MACKENZIE NORTH TECHNOLOGY CENTRE



A Northern Equities  
Group Development

From 6,000 to  
55,200 SQ. FT.

Contact:  
Matt Sosin/Joe Drolshagen

**248-848-6400**





HAGGERTY CORRIDOR  
CORPORATE PARK II

MALKENZEL

WACHSHEIM NORTH TECHNOLOGY CENTER  
248-848-6400



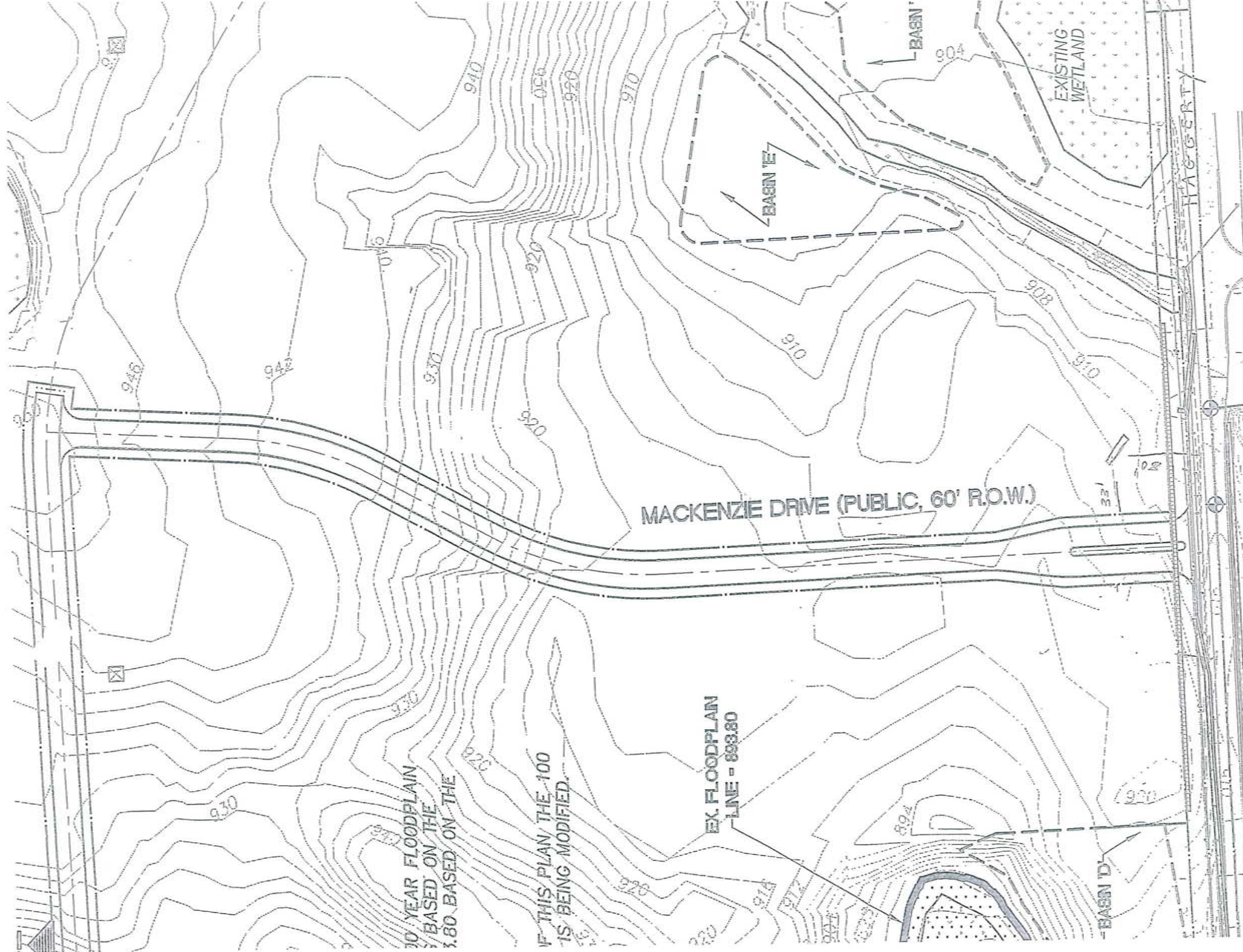

MACKENZIE DRIVE (PUBLIC, 60' R.O.W.)

10 YEAR FLOODPLAIN  
BASED ON THE  
1.80 BASED ON THE

IF THIS PLAN THE 100  
IS BEING MODIFIED.

EX. FLOODPLAIN  
LINE = 893.80

EXISTING  
WETLAND

BASIN F

BASIN E

BASIN D

HAGGERTY

115