

PRID.1 (Scale is 1/2" = 1')
DOUBLE SIDED ILLUMINATED ENTRY SIGN

Side View



—visualentities

These designs, details and plans represented herein are the property of Visual Entities. Specifically developed for your personal use in connection with the project being planned for you by Visual Entities. It is not to be shown to anyone outside your organization, nor is it to be used, reproduced, exhibited or copied in any fashion whatsoever. All designs (exception registered trademarks) remain the property of Visual Entities.

Primary Identification Sign PRID.1 Exterior Signage

PROJECT: Novi Orthopaedic Center
DATE: 12.03.08
DRAWING NO: 4741

NOVI ORTHOPAEDIC
CENTER

26750 Providence Pkwy
Novi, MI

① EXISTING
DIRECTIONAL
SIGN

PROVIDENCE PARKWAY

⑤ EXISTING
DIRECTIONAL
SIGN

② EXISTING SIGN
RELATING TO
THE VARIANCE

③ EXISTING
DIRECTIONAL
SIGN

④ EXISTING
DIRECTIONAL
SIGN

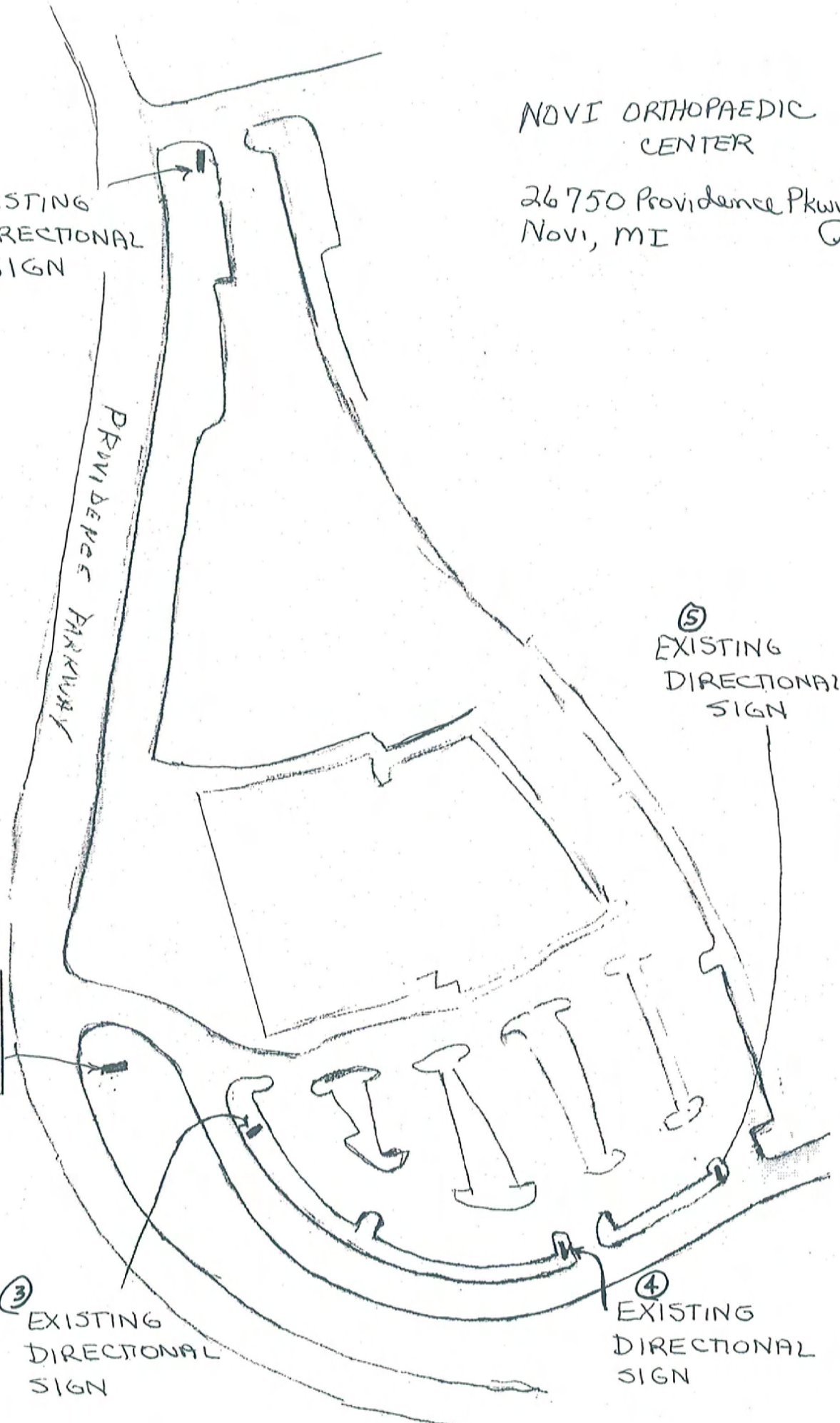



1. Providence Park Hospital
47601 Grand River Avenue

2. Medical Office Building
26850 Providence Parkway

3. Neurosciences Institute
26850 Providence Parkway

4. The Novi Orthopaedic Center,
and The Bone and Joint Center of Novi
26750 Providence Parkway

5. Staybridge Suites
27000 Providence Parkway

6. Assarian Cancer Center

7. Outpatient Center