

**Huntington  
Custom Monument**

**Gardner  
signs**

|   |  |
|---|--|
| 1095 Naughton Dr.<br>Troy, MI 48083<br>(248) 689-9100 T<br>(248) 689-9101 F | 3800 Airport Hwy<br>Toledo, OH 43615<br>(419) 385-6669 T<br>(419) 385-7046 F |
|---|--|

www.gardnersigns.com

|              |                              |
|--------------|------------------------------|
| CLIENT:      | Huntington                   |
| PROJECT:     | Aluminum Faced Monuments     |
| LOCATION:    | 43200 10 Mile Rd.<br>Novi MI |
| SALESPERSON: | Jeff Prymas                  |
| DESIGNER:    | Troy Krieger                 |
| DATE:        | 11/2/07                      |
| DESIGN #:    |                              |
| REVISIONS:   |                              |
| SCALE:       | 1/2in=1ft                    |

**SALES AUTHORIZATION**

SIGNED BY:  
DATE:

**DESIGN AUTHORIZATION**

SIGNED BY:  
DATE:

**PRODUCTION AUTHORIZATION**

CLIENT APPROVAL:  
DATE:  
PRODUCTION APPROVAL:  
DATE:

DESIGN AND COLOR RENDERING COPYRIGHT 2006 BY GARDNER SIGNS, INC. SUBMITTED FOR YOUR USE WITH THIS DESIGN PROJECT. IT IS NOT TO BE TRANSMITTED, USED, COPIED, ALTERED OR EXHIBITED IN ANY FASHION WHATSOEVER. ALL OR ANY PART OF THIS DESIGN (EXCEPT REGISTERED TRADEMARKS) REMAINS THE EXCLUSIVE PROPERTY OF GARDNER SIGNS, INC.

COLORS CONTAINED WITHIN THIS RENDERING MAY VARY SLIGHTLY FROM THE ACTUAL FINISHED PRODUCT DUE TO COMPUTER AND PRINTER OUTPUT LIMITATIONS.

White  
Translucent

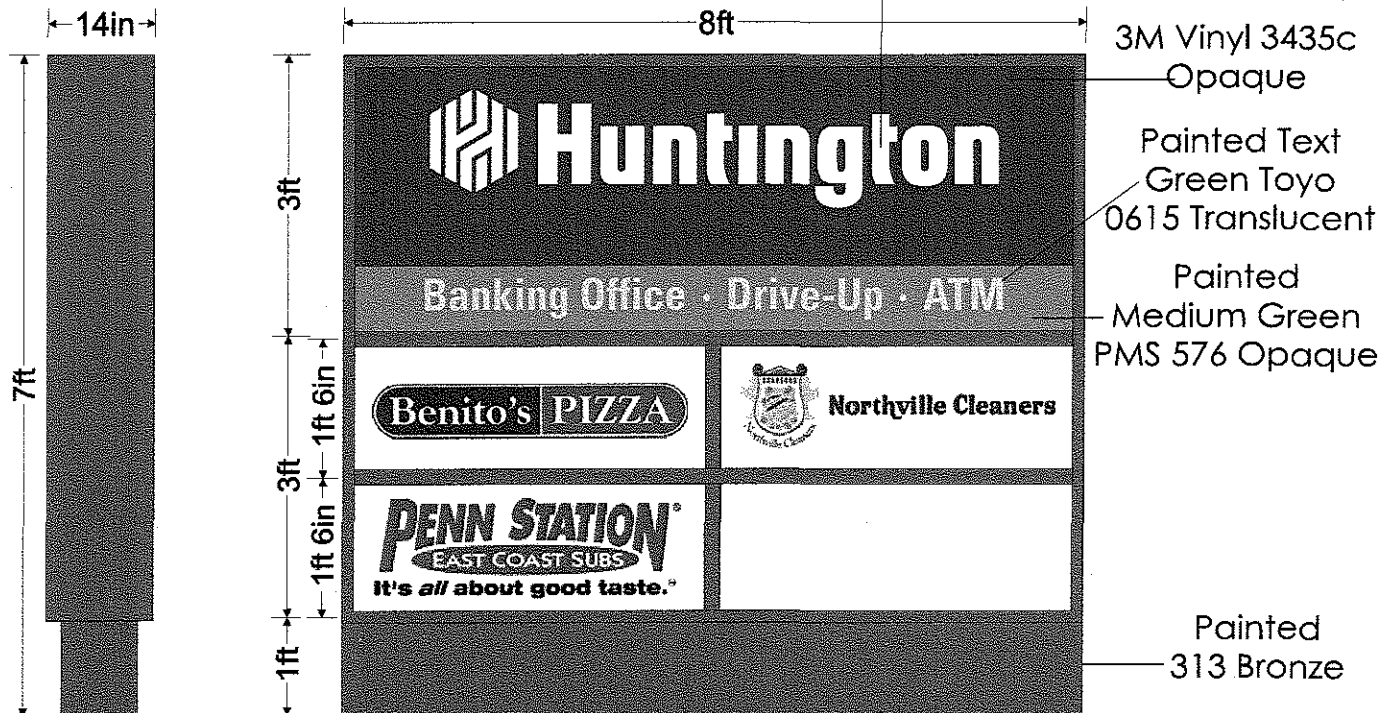

Gardner Signs to manufacture and install one Internally illuminated aluminum monument sign. Lexan faces to be decorated with 3M translucent vinyl and paint matching standard Huntington colors. Illumination by daylight high output fluorescent bulbs. All electrical to be UL listed.

**Huntington  
Custom Monument  
Footer detail**

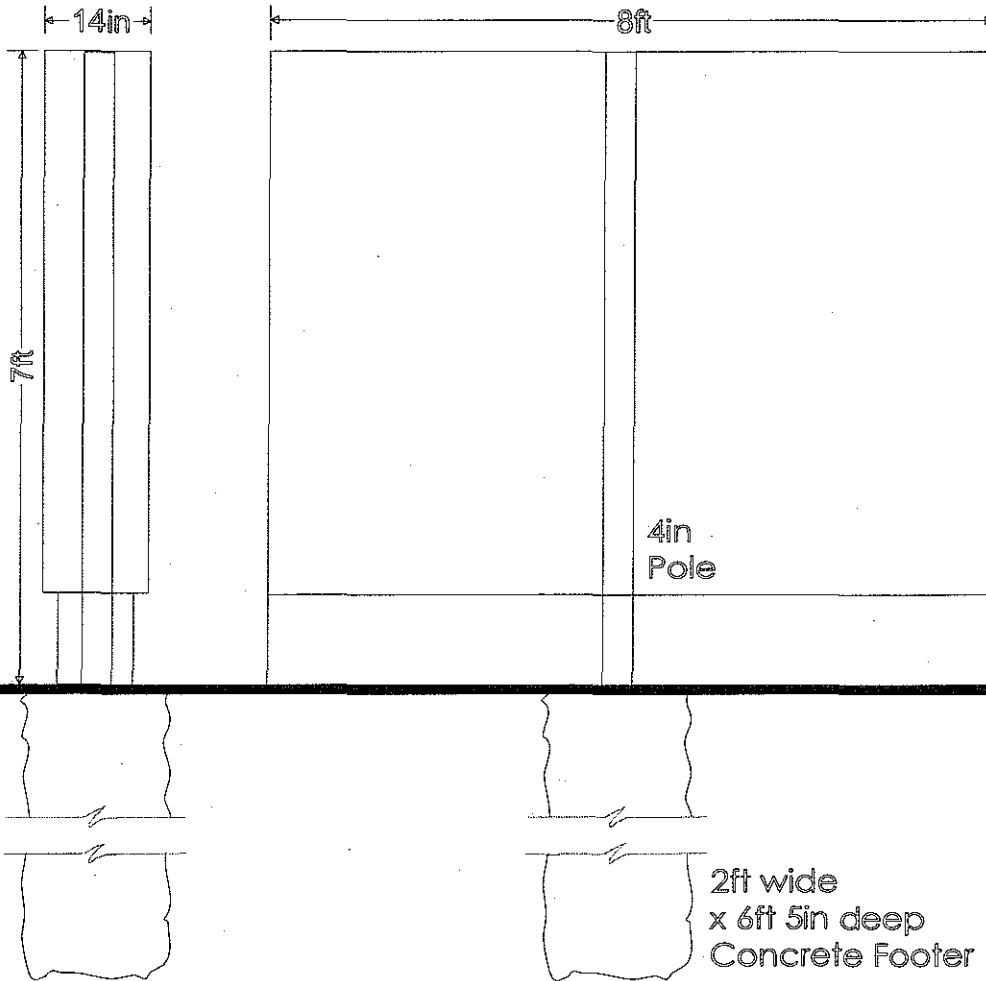

Gardner Signs to manufacture and install one Internally illuminated aluminum monument sign. Lexan faces to be decorated with 3M translucent vinyl and paint matching standard Huntington colors. Illumination by daylight high output fluorescent bulbs. All electrical to be UL listed.

**Gardner  
signs**

|   |  |
|---|--|
| 1016 Naughton Dr.<br>Troy, MI 48063<br>(248) 689-9100 T<br>(248) 689-9101 F | 3800 Airport Hwy<br>Toledo, OH 43615<br>(419) 385-6669 T<br>(419) 385-7046 F |
|---|--|

www.gardnersigns.com

|              |                              |
|--------------|------------------------------|
| CLIENT:      | Huntington                   |
| PROJECT:     | Aluminum Faced Monuments     |
| LOCATION:    | 43200 10 Mile Rd.<br>Novi MI |
| SALESPERSON: | Jeff Prynias                 |
| DESIGNER:    | Troy Krieger                 |
| DATE:        | 11/2/07                      |
| DESIGN #:    |                              |
| REVISIONS:   |                              |
| SCALE:       | 1/2in=1ft                    |

| SALES AUTHORIZATION |  |
|---------------------|--|
| SIGNED BY:          |  |
| DATE:               |  |

| DESIGN AUTHORIZATION |  |
|----------------------|--|
| SIGNED BY:           |  |
| DATE:                |  |

| PRODUCTION AUTHORIZATION |  |
|--------------------------|--|
| CLIENT APPROVAL:         |  |
| DATE:                    |  |
| PRODUCTION APPROVAL:     |  |
| DATE:                    |  |

DESIGN AND COLOR RENDERING COPYRIGHT 2006 BY GARDNER SIGNS, INC. SUBMITTED FOR YOUR USE WITH THIS DESIGN PROJECT. IT IS NOT TO BE TRANSMITTED, USED, COPIED, ALTERED OR EXHIBITED IN ANY FASHION WHATSOEVER. ALL OR ANY PART OF THIS DESIGN (EXCEPT REGISTERED TRADEMARKS) REMAINS THE EXCLUSIVE PROPERTY OF GARDNER SIGNS, INC.

COLORS CONTAINED WITHIN THIS RENDERING MAY VARY SLIGHTLY FROM THE ACTUAL FINISHED PRODUCT DUE TO COMPUTER AND PRINTER OUTPUT LIMITATIONS.

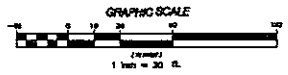
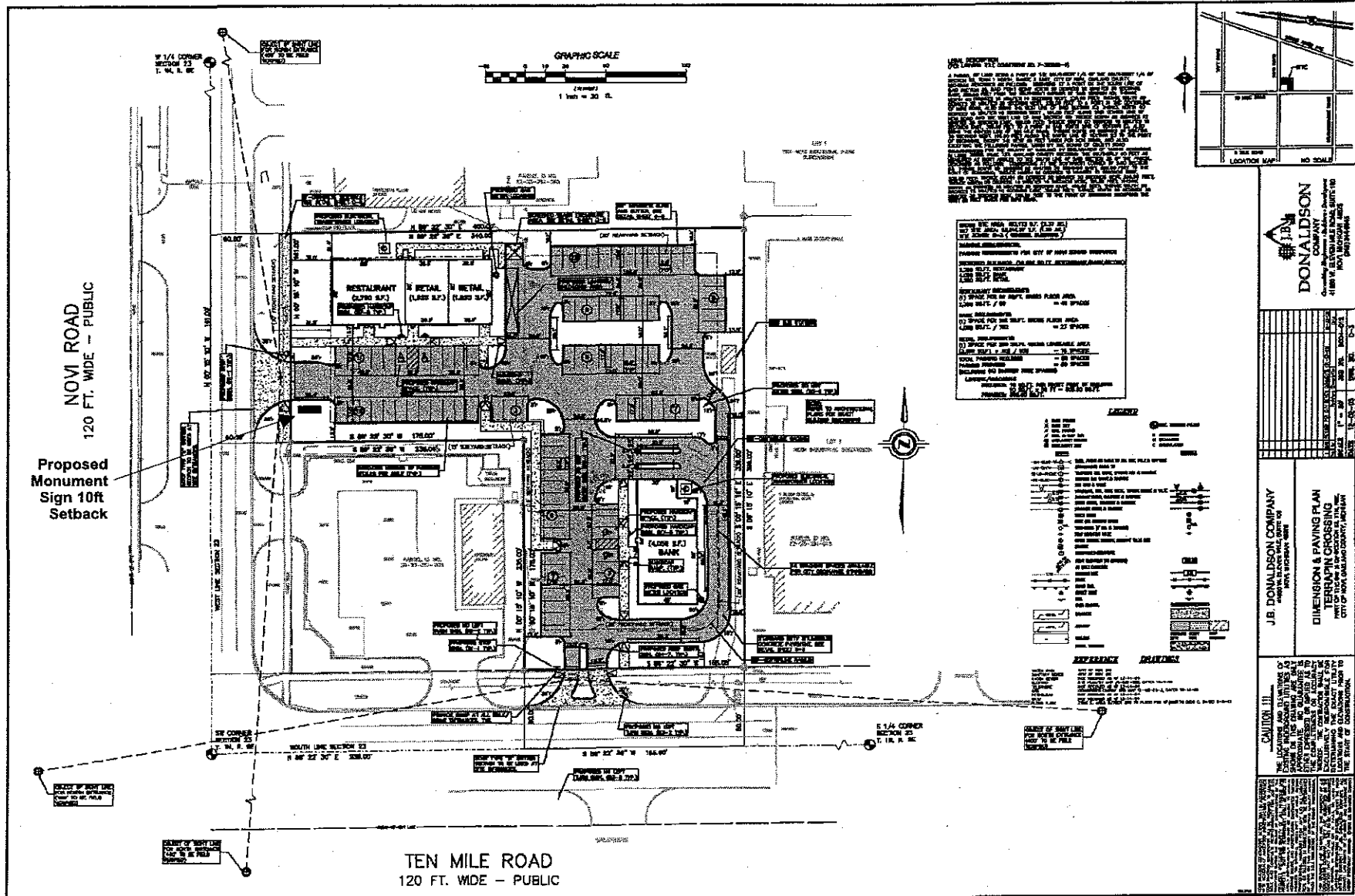

**NOTES:**  
 1. ALL DIMENSIONS ARE TO FACE UNLESS NOTED OTHERWISE.  
 2. ALL DIMENSIONS ARE TO FACE UNLESS NOTED OTHERWISE.  
 3. ALL DIMENSIONS ARE TO FACE UNLESS NOTED OTHERWISE.  
 4. ALL DIMENSIONS ARE TO FACE UNLESS NOTED OTHERWISE.  
 5. ALL DIMENSIONS ARE TO FACE UNLESS NOTED OTHERWISE.  
 6. ALL DIMENSIONS ARE TO FACE UNLESS NOTED OTHERWISE.  
 7. ALL DIMENSIONS ARE TO FACE UNLESS NOTED OTHERWISE.  
 8. ALL DIMENSIONS ARE TO FACE UNLESS NOTED OTHERWISE.  
 9. ALL DIMENSIONS ARE TO FACE UNLESS NOTED OTHERWISE.  
 10. ALL DIMENSIONS ARE TO FACE UNLESS NOTED OTHERWISE.

**TABLE 1: SUMMARY OF AREAS**

| DESCRIPTION           | AREA (SQ. FT.) |
|-----------------------|----------------|
| RESTAURANT (CLASS 37) | 10,000         |
| RETAIL (CLASS 37)     | 15,000         |
| BANK (CLASS 37)       | 8,000          |
| OFFICE (CLASS 37)     | 12,000         |
| PARKING               | 20,000         |
| LANDSCAPING           | 5,000          |
| TOTAL                 | 70,000         |

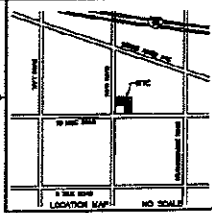
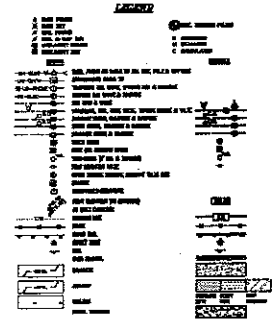

**DONALDSON COMPANY**  
 CIVIL ENGINEERS  
 10000 W. 100th Ave.  
 Suite 100  
 Overland Park, MO 66210  
 Phone: (913) 666-1100  
 Fax: (913) 666-1101

**J.B. DONALDSON COMPANY**  
 CIVIL ENGINEERS  
 10000 W. 100th Ave.  
 Suite 100  
 Overland Park, MO 66210  
 Phone: (913) 666-1100  
 Fax: (913) 666-1101

**CAUTION!!!**  
 THE LOCATIONS AND DIMENSIONS OF THE MONUMENT SIGN ARE APPROXIMATE AND SUBJECT TO CHANGE. THE ENGINEER'S RESPONSIBILITY IS FOR THE LOCATION AND DIMENSIONS OF THE SIGN AS SHOWN ON THIS PLAN AND NOT FOR THE LOCATION AND DIMENSIONS OF THE SIGN AS SHOWN IN THE FIELD.

**NOVI ROAD**  
 120 FT. WIDE - PUBLIC

**Proposed Monument Sign 10ft Setback**

**TEN MILE ROAD**  
 120 FT. WIDE - PUBLIC